

## L3\*890-40T32-I

### Multi-Chip Type LED

This product consists of AlGaAs LED mounted with AlN heat sink pedestal on TO-18 stem 2pins type stem with a glass ball lens can. Three chips are connected as series.

#### <Features>

- High Radiated Intensity
- High Reliability

#### <Specifications>

1. Product Name: Infrared LED Lamp
2. Type Number: L3\*890-40T32-I
3. Chip:
  - Chip material: AlGaAs
  - Peak Wavelength: 890nm
  - Dimension: 400um x 400um
  - Connection: Series
4. Package:
  - Stem: TO-18, 5pins type
  - Lens: Spherical Glass Lens
  - Cap: Gold Plated

Outer Dimension (Unit:mm)

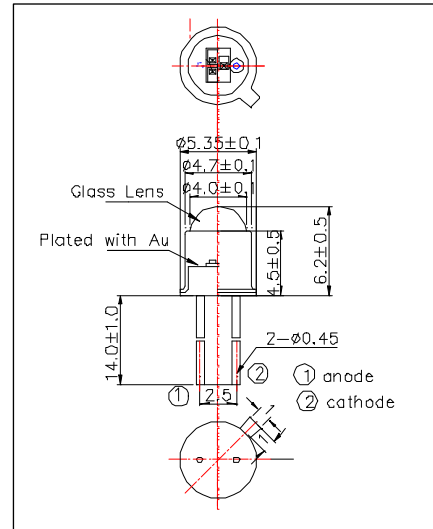

Absolute Maximum Ratings[Ta=25°C]			
Item	Symbol	Maximum Rated Value	Unit
Power Dissipation	PD	500	mW
Forward Current	IF	100	mA
Pulse Forward Current*	IFP	200	mA
Reverse Voltage	VR	5	V
Operating Temperature	TOPR	-30 ~ +80	°C
Storage Temperature	TSTG	-30 ~ +100	°C
Soldering Temperature**	TSOL	260	°C

\* Duty=1% and Pulse Width=10μs

\*\* Soldering condition must be completed within 3 seconds at 260°C

Electro-Optical Characteristics						
Item	Symbol	Condition	Min.	Typ.	Max.	Unit
Forward Voltage	VF	IF=50mA		4.2	5.0	V
Reverse Current	IR	VR=5V			10	μA
Total Radiated Power*	PO	IF=50mA		24		mW
Radiant Intensity**	IE	IF=50mA		(25)		mW/sr
Peak Wavelength	λP	IF=50mA		890		nm
Half Width	Δλ	IF=50mA		65		nm
Viewing Half Angle	θ1/2	IF=50mA		-		deg
Rise Time	tr	IF=50mA		80		ns
Fall Time	tf	IF=50mA		400		ns

\* Measured by Photodyne #500

\*\* Measured by Tektronix J-6512

