

# SMT850-27

High Performance Infrared TOP LED with Lens

SMT850-27 consists of an AlGaAs LED mounted on the lead frame as TOP LED package with plastic ball lens and is 44mW typical of output power and 40mW/sr of radiant Intensity. It emits a spectral band of radiation at 850nm.

◆ Outer dimension (Unit:mm)

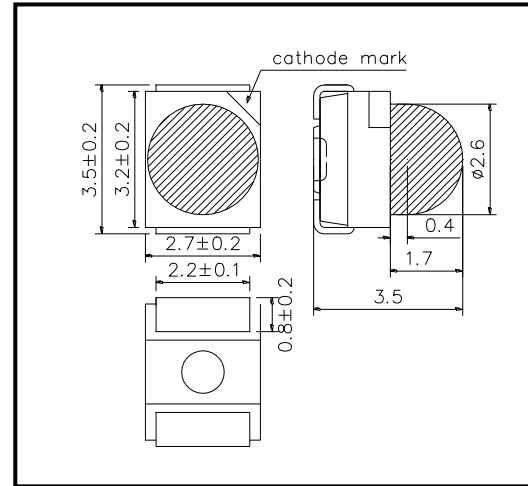

◆ Specifications

- 1) Product Name TOP IR LED
- 2) Type No. SMT850-27
- 3) Chip
  - (1) Chip Material AlGaAs
  - (2) Chip Dimension 400um\*400um
  - (3) Peak Wavelength 850nm typ.
- 4) Package
  - (1) Lead Frame Die Silver Plated
  - (2) Package Resin PPA Resin
  - (3) Lens Epoxy Resin
  - (4) Diameter Φ2.6mm

◆ Absolute Maximum Rating

Item	Symbol	Maximum Rated Value	Unit	Ambient Temperature
Power Dissipation	P <sub>D</sub>	160	mW	T <sub>a</sub> =25°C
Forward Current	I <sub>F</sub>	100	mA	T <sub>a</sub> =25°C
Pulse Forward Current	I <sub>FP</sub>	500	mA	T <sub>a</sub> =25°C
Reverse Voltage	V <sub>R</sub>	5	V	T <sub>a</sub> =25°C
Operating Temperature	T <sub>OPR</sub>	-20 ~ +80	°C	
Storage Temperature	T <sub>STG</sub>	-30 ~ +80	°C	
Soldering Temperature	T <sub>SOL</sub>	255	°C	

‡Pulse Forward Current condition: Duty=1% and Pulse Width=10us.

‡Soldering condition: Soldering condition must be completed within 10 seconds at 255°C

◆ Electro-Optical Characteristics [T<sub>a</sub>=25°C]

Item	Symbol	Condition	Minimum	Typical	Maximum	Unit
Forward Voltage	V <sub>F</sub>	I <sub>F</sub> =50mA DC		1.45	1.60	V
		I <sub>F</sub> =100mA, t <sub>p</sub> =20ms		1.50	1.8	
Reverse Current	I <sub>R</sub>	V <sub>R</sub> =5V			10	uA
Total Radiated Power	P <sub>O</sub>	I <sub>F</sub> =50mA DC	16.0	22.0		mW
		I <sub>F</sub> =100mA, t <sub>p</sub> =20ms		44.0		
Radiant Intensity	I <sub>E</sub>	I <sub>F</sub> =50mA DC		20		mW/sr
		I <sub>F</sub> =100mA, t <sub>p</sub> =20ms		40		
Peak Wavelength	λ <sub>P</sub>	I <sub>F</sub> =50mA DC	835	850	865	nm
Half Width	Δλ	I <sub>F</sub> =50mA DC		40		nm
Viewing Half Angle	θ <sub>1/2</sub>	I <sub>F</sub> =50mA DC		±28		deg.
Rise Time	t <sub>r</sub>	I <sub>F</sub> =50mA DC		15		ns
Fall Time	t <sub>f</sub>	I <sub>F</sub> =50mA DC		10		ns

‡Total Radiated Power is measured by Photodyne #500

‡Radiant Intensity is measured by Tektronix J-6512.

◆ SMD Application  
IR-Reflow Soldering Profile for lead free soldering

Recommended Land Layout (Unit: mm)

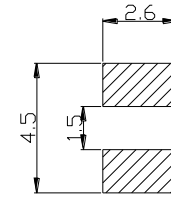
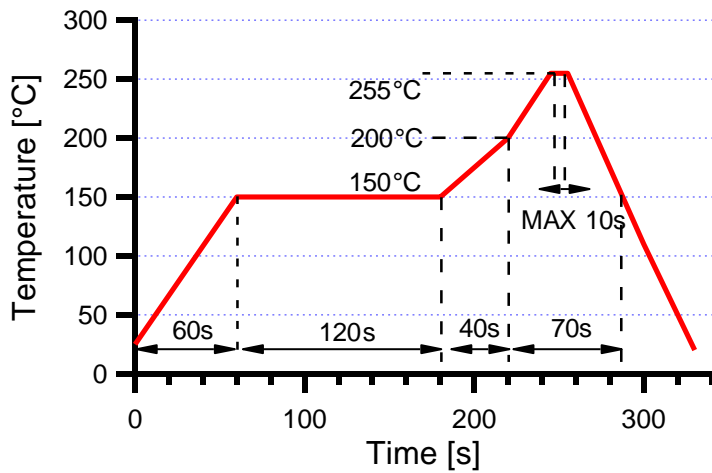

Don't put stress on SMD and a circuit board after soldering.

◆ SMD Packing  
Tape and Reel Dimensions (Unit: mm)

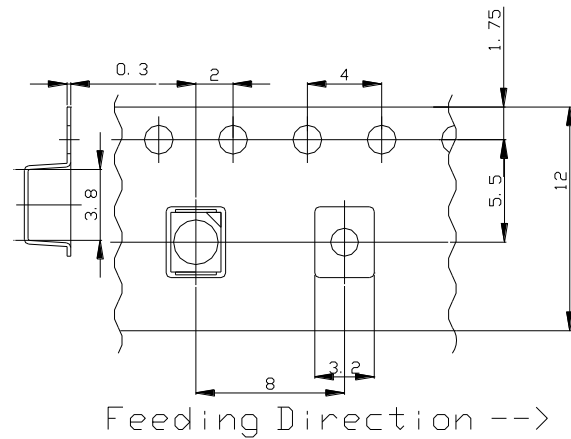
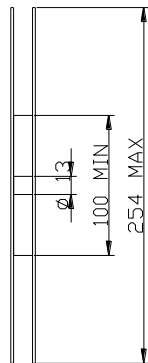
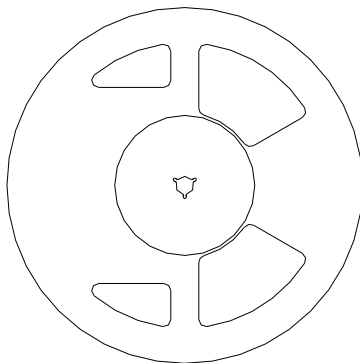

◆ Wrapping

Moisture barrier bag aluminum laminated film with a desiccant to keep out the moisture absorption during the transportation and storage.

## SMD LED STORAGE AND HANDLING PRECAUTIONS

### < Storage Conditions before Opening a Moisture-Barrier Aluminum Bag >

- Before opening a moisture-barrier aluminum bag, please store it at <30°C, <60%RH. Please note that the maximum shelf life is 12 months under these conditions.

### < Storage Conditions after Opening a Moisture-Barrier Aluminum Bag >

- After opening a moisture-barrier aluminum bag, store the aluminum bag and silica gel in a desiccator.
- After opening the bag, please solder the LEDs within 48 hours in a room with 5 - 30°C, <50%RH.
- Please put any unused, remaining LEDs and silica gel back in the same aluminum bag and then vacuum-seal the bag.
- It is recommended to keep the re-sealed bag in a desiccator at <30%RH.

### < Notes about Re-sealing a Moisture-Barrier Aluminum Bag >

- When vacuum-sealing an opened aluminum bag, if you find the moisture-indicator of the silica gel has changed to pink from blue (indicating a relative humidity of 30 % or more), please do not use the unused LEDs, the aluminum bag, or the silica gel.

### < Notes about Opening a Re-sealed Moisture-Barrier Aluminum Bag >

- When opening a vacuumed and re-sealed aluminum bag in order to use the remaining LEDs stored in the bag, if you find that the moisture-indicator of the silica has changed to pink, please do not use the LEDs.

※The 48-hour- long floor life does not include the time while LEDs are stored in the moisture-barrier aluminum bag.  
However, we strongly recommend to solder the LEDs as soon as possible after opening the aluminum bag.