

L505-66-60 epoxy lens type Bluish Green color illuminator

L505-66-60 is a wide viewing and extremely high output power illuminator assembled with a total of 60 high efficiency InGaN diode chips, mounted on a metal stem TO-66 with AlN ceramics and covered with double coated clear silicone and epoxy resin. These devices are designed for high current operation with proper heat sinking to improve thermal conductive efficiency.

Features

- 1) High reliability
- 2) Compact (TO-66) package
- 3) High output power at 505nm

Applications

- 1) For high intensity lighting source

Specifications

- | | |
|---------------------|--------------------------------|
| 1) Product name | Bluish Green color illuminator |
| 2) Spec. No. | L505-66-60 |
| 3) Chip | |
| (1) Material | InGaN |
| (2) Peak wavelength | 505nm |
| 4) Package | |
| (1) Stem | TO-66 stem with AlN |
| (2) Lens | Clear silicone and epoxy lens |

Outer dimension (Unit: mm)

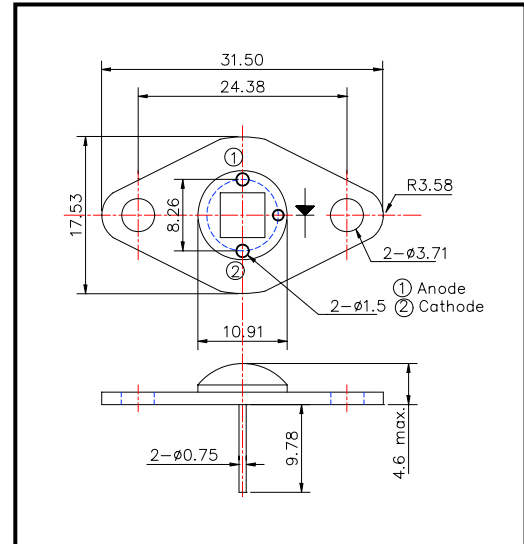

Absolute Maximum Ratings

Item	Symbol	Maximum Rated Value	Unit	Ambient Temp.
Power Dissipation	P _D	7.8	W	T _a =25°C
Forward Current	I _F	400	mA	T _a =25°C
Pulse Forward Current	I _{FP}	2000	mA	T _a =25°C
Reverse Voltage	V _R	50	V	T _a =25°C
Operating Temperature	T _{OPR}	-30 ~ +80	°C	
Storage Temperature	T _{STG}	-30 ~ +110	°C	
Soldering Temperature	T _{SOL}	240	°C	

‡Pulse Forward Current condition: Duty=1% and Pulse Width=1us.

‡Soldering condition: Soldering condition must be completed within 3 seconds at 260°C

Electro-Optical Characteristics

Item	Symbol	Condition	Minimum	Typical	Maximum	Unit
Forward Voltage	V _F	I _F =240mA		18.5		V
Brightness	I _v	I _F =240mA		4500		mcd
Total Radiated Power	P _o	I _F =240mA		60		mW
Radiant Intensity	I _E	I _F =240mA		10		mW/sr
Reverse Current	V _R	I _R =10uA	30			V
Peak Wavelength	λ _P	I _F =240mA	495	505	515	nm
Half Width	Δλ	I _F =240mA		30		nm
Viewing Half Angle	Q _{1/2}	I _F =240mA		±60		deg.

‡Heat sink is required thermal resistance <8K/W

Marubeni

Marubeni America Corporation

3945 Freedom Circle, Suite 1000, Santa Clara, CA 95054

408-330-0650 (Ext. 323), 408-330-0655 (Fax), sales@tech-led.com